



PEGASO

S.r.l.

SW94370307

CHARTER

SW94
BRACON



Aragon is built to be safe, reliable and seaworthy. Performance sport is at her core but she is equally proud of the cruising comfort she offers.

Versatile and lightweight, Aragon weighs just 53 tons and is built to perform in light Mediterranean breezes and take on the open seas with ease.

Thanks to advanced construction techniques, an outstanding design and racing equipment, Aragon assures exciting and comfortable sailing in any weather conditions.



SW94
aragon



SW94
aragon



A highly qualified multilingual crew is trained to meet the most exclusive guest's needs. Amazing sailing, fascinating anchorages and tasteful cuisine experiences.



Mutual privacy and dedicated spaces are some of the key elements for a happy cruise.
The Italian flair of Southern Wind and of Nauta Design lies behind the simplicity and the elegance of Aragon look.
A warm atmosphere and smooth functionality make guests feel home.





SW94
aragon

Interior and exterior layouts are designed to assure a sense of comfort to guests and crew.
Aragon has homey living spaces that are light, luminous, well proportioned and, above all, functional.



SW94
aragon



MASTER CABIN

Stateroom forward is the quietest and most private area of the yacht: a full-beam cabin with storage spaces and an en-suite bathroom.

Wide, comfortable beds, handy shelves, drawers and closets, spacious and well-lit heads: identical guest cabins mean that friends and family are treated with the same regard.





SINGLE GUEST CABIN

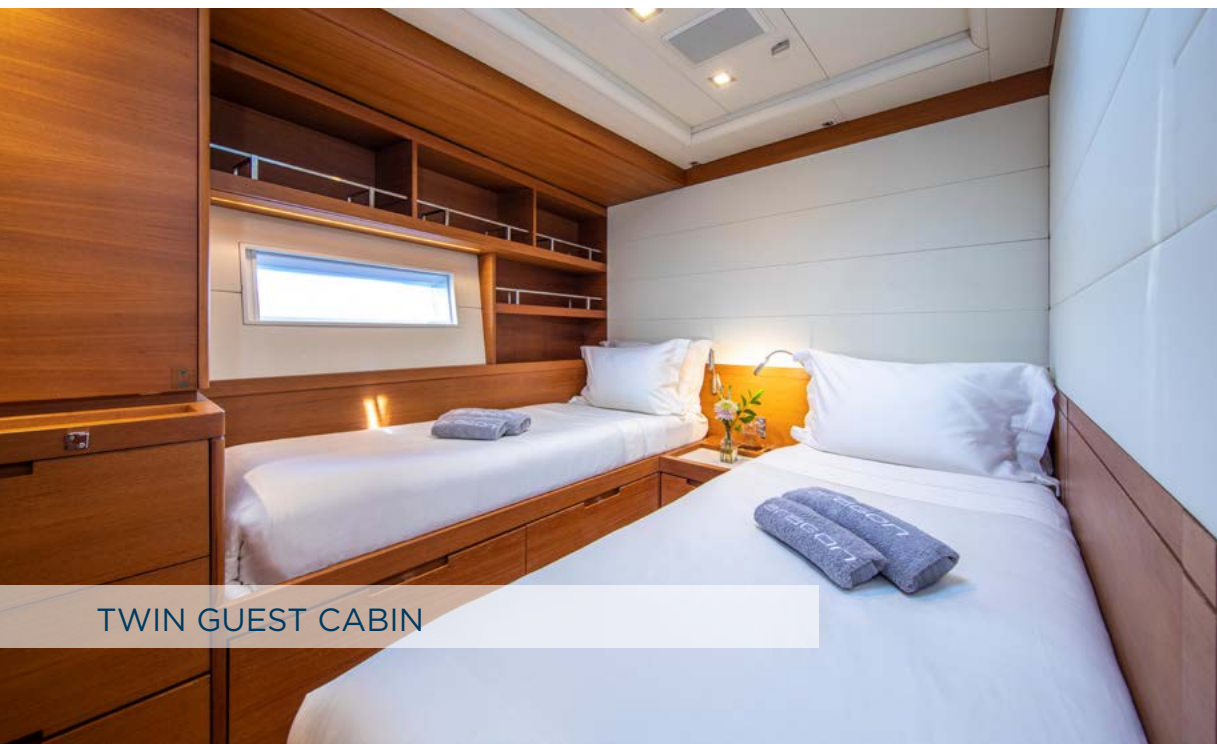

TWIN GUEST CABIN



CREW AREA



KEY FEATURES

- Fast and comfortable cruiser-racer designed by Reichel-Pugh and built by Southern Wind
- Spacious interior layouts by Nauta design
- Winner of many superyacht regattas including The Voiles de St Barth
- Large cockpit table and sunbeds
- Dodger + Bimini

LAYOUT

7+1 guests in 4 cabins:

Guest cabins configuration: 2 Twin, 1 Single, 1 Double

Bed Configuration: 1 Queen, 6 Single (1 lifting bunk)

4 crew in 2 cabins

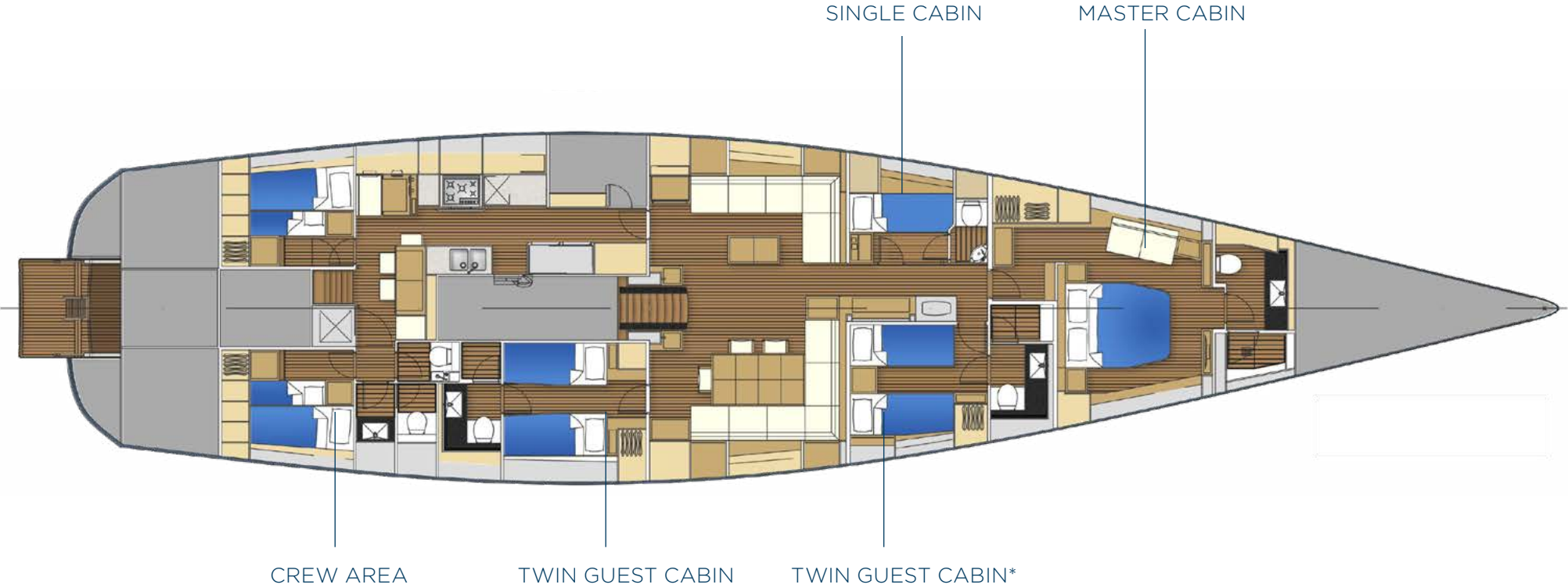
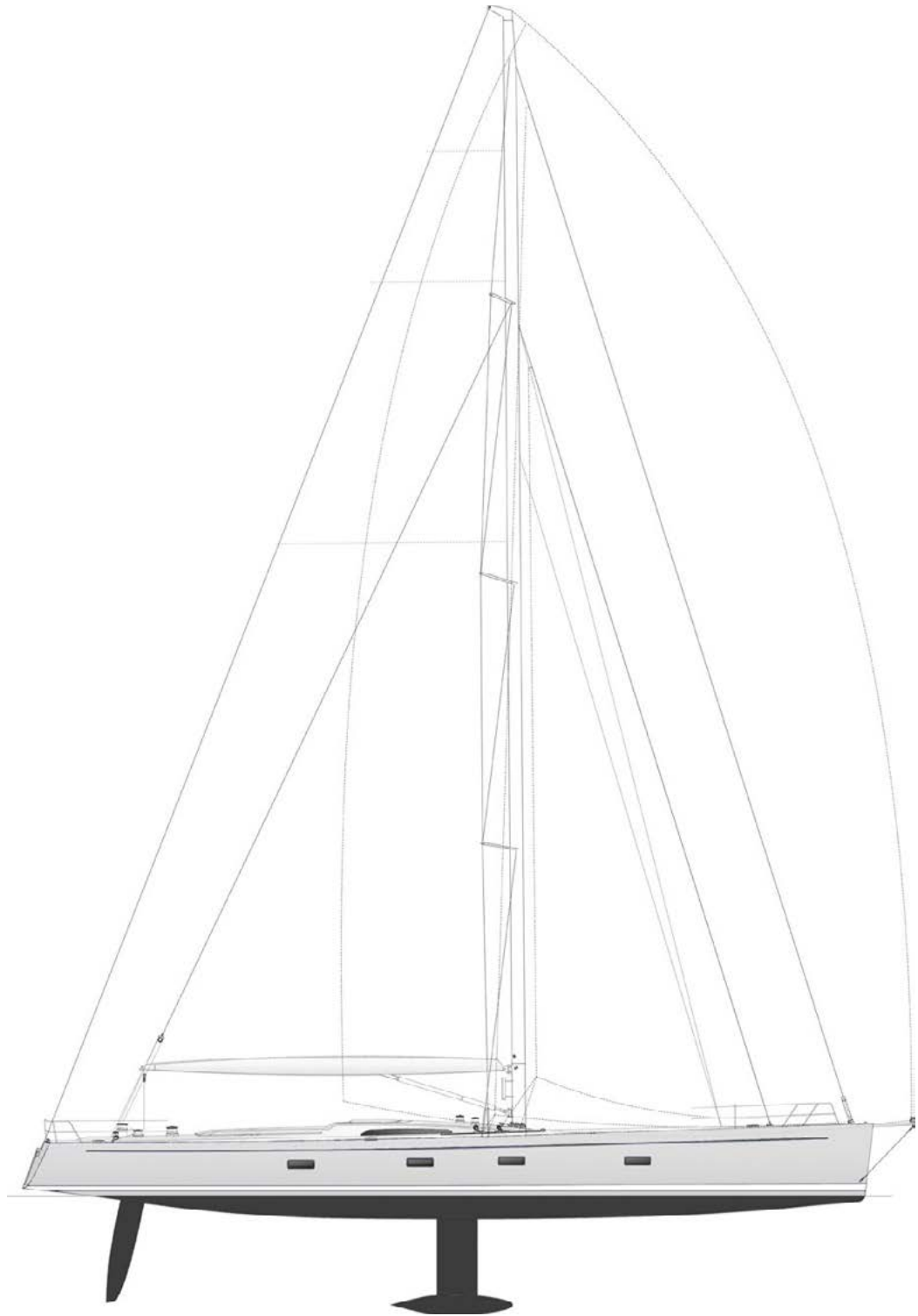

*TWIN BEDS CAN BE JOINED TO BECOME QUEEN SIZED BED

SPECS

Year of construction: 2013 | Refit 2019

Flag: Malta

MAIN DATA

LOA: 28.64 m

LWL: 26.0 m

BEAM (MAX): 6.60 m

DRAFT: 4.50 m

DISPLACEMENT: 53 tons

DESIGNERS

NAVAL ARCHITECT: Reichel-Pugh Yacht Design

DECK AND INTERIOR DESIGN: Nauta Design

TENDER & TOYS

TENDER:

Falcon 450 with 40Hp engine outboard

TOYS:

3 x Standing paddleboard and equipment

2 x Wakeboard and equipment

1 x Aquagilde Syncro Towable Tube +
Tow Float Rope

6 x PFD Vest (Adult)

6 x Water Float Noodles

Snorkel Equipment



Disclaimer

The Company offers the details of this vessel in good faith but cannot guarantee or warrant the accuracy of this information nor warrant the condition of the vessel. A buyer should instruct his agents, or his surveyors, to investigate such details as the buyer desire validated. This vessel is offered subject to prior sale, price change, or withdrawal without notice. This specification/inventory will only form part of the contract when attached to a sales contract that has been signed and agreed by both seller and buyer.



SW94
aragon

PEGASO

S.r.l.

Salita Dinegro 7/1, 16123
Genova, Italy

Ph. +39 010 570 4035
charter@pegasoyd.com

www.sws-yachts.com